

BERNINA 



Additions for manual artista 730

Artistic View Provides a preview of the motif in actual stitches.

- Select an embroidery motif or an alphabet in embroidery Mode.
- Select *Design Information* from the *Edit* screen.



- Design information is displayed.
- Press *Scroll Forward*.

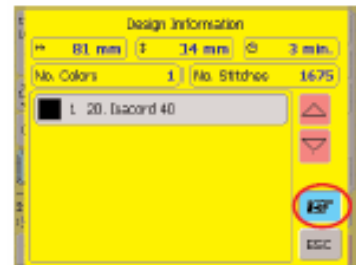

- The *Artistic View* screen appears and the motif is displayed in artistic view.
- Press *Scroll Backwards* to close the screen.
- Touch *Esc* to return to the Edit Screen.



Speed Control

A **Speed calibration** must be performed if:

- the Needle Stop position is incorrect
- **needle stop position or a lack of responsiveness by the foot control when raising/lowering the needle is present** (back heel kick).

Preparation

- Select straight stitch no. 1
- Lower feed dogs
- Remove presser foot and remove threads

Open Setup Program

- Press *Setup* button; the selection menu appears.
- Touch *Hardware*; touch **Reg. S.P.M.**



Checking Max Speed

- Touch *Reg S.P.M.* the *Check Speed* screen appears.
- Press foot control, ease off slightly then press down completely.
- The current speed (S.P.M) is displayed. If the speed is over 950 S.P.M., a speed calibration must be performed. Touch *Esc.* to close the screen.

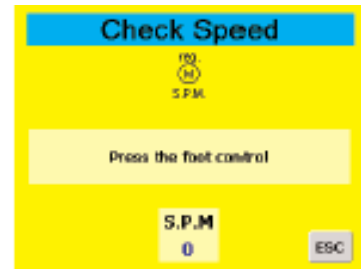

Calibrating the Speed

- Touch *Max S.P.M.* , the *Speed Calibration* screen appears.
- Press the foot control until the sewing computer stops. If the calibration was successful, a green *OK* will display. If a red *X* appears, repeat the calibration process.
- Follow the prompts on the screen to close the window.

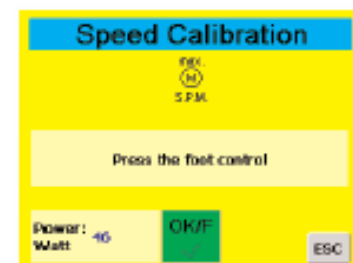

USB-Stick

- The USB data stick has 256 MB disk space.
- Never remove the USB stick when data is being processed (recalculation of stitches, for example) or when WordArt is still active.



General information:



Securing Function (with 4 stitches) (p. 32)

- Activate the *Securing Function* before sewing, while *Pattern Begin* is active; the sewing computer will secure the beginning and the end of the first stitch with four small stitches. The machine will not stop stitching after securing.
- Activate the *Securing Function* before or while sewing, to secure only at the end of the actual stitch. The sewing computer will not stop sewing after securing.
- Activate the *Securing Function* while sewing individual stitches, the stitches will be secured at the end and the machine will continue to stitch.
- Activate the *Securing Function* and *Pattern End* before beginning to sew or while sewing, the sewing computer stops after securing at the end of the individual stitch pattern.
- When programming the *Securing Function* within a stitch combination, each pattern will be secured at the beginning and at the end.



Securing Program (pg 32)

- For security, center needle position is selected and cannot be changed while the function is active.



Long Stitch (pg 30)

- The *Long Stitch* function may be used with all utility and decorative stitches, it is not available for use with the buttonholes and sideways motions stitches.
- Triple straight stitch #6 may result in unsatisfactory stitch quality when combined with the *Long Stitch* function; use new stitch #31 instead. Stitch #31 in combination with *Long Stitch* will result in a stitch length of 10mm.



Quilters Securing Program (pg 138)

- Stitch #1324 automatically secures the stitching with 5 short securing stitches forward at the beginning and the end of the seam.
- Note the stitches found on the Quilt Menu (300 series stitches) are prefixed with a 1 (ie. #324 is now #1324).



Spinning Spool (pg 206)

- A *Spinning Spool* indicates data being calculated. When the spool is present, do not insert or remove any external devices (ie. USB Stick, PC cables etc) or attempt to make any changes on the screen.
- In the event the spool continues to spin, switch the embroidery computer off and on again.

General information:

Scrolling through Stitch Menus

- Scrolling within a stitch menu results in the full screen of stitches scrolling rather than one row of stitches at a time.

Embroidery –computer working memory

- When the working memory of the embroidery computer is near capacity, the following message will appear on screen: *“Please save your current motif. Your embroidery computer memory has nearly reached its limit. Switch your embroidery computer off and on again to continue.”*

Embroidery Hoop

- Calibrate the embroidery module using the oval hoop before the initial use of the module. Calibrate the module with the template imprinted with the purple grid.

Correct fit of bobbin case brake spring:

- Insert the bobbin case brake spring into the bobbin case as shown in the drawing, ensuring that the four brake cams (thin arrows) engage into the bobbin case notches (**see** arrows).

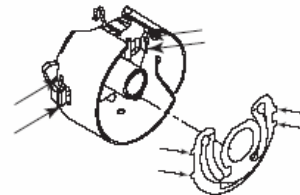

Stitch Counter:

- To view the number of stitches sewn on the embroidery computer, select the Setup Menu.
- Select Hardware. Select the last icon as shown.
- The top box tracks the number of stitches sewn, the bottom box tracks the number of stitches since the last service.

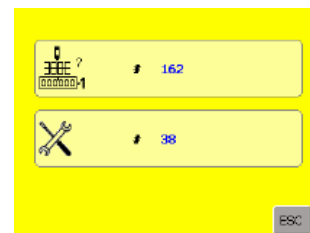
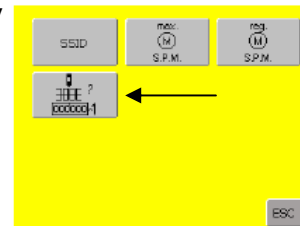

Maintenance:

- When the sewing/embroidery computer is brought to the local Bernina Dealer for service, be sure to include the #3A buttonhole foot with slide.

BERNINA

Matter 

EN/DE 07/05 032 767 50 00